

PUBLIC NOTICE

TAKE NOTICE that the Federal Highway Administration intends to make a *de minimis* impact finding for use of a park under Section 4(f) of the Department of Transportation Act of 1966 at Campbell Park (Block 89, Lot 16) in the Township of Lakewood, Ocean County, New Jersey. The Federal Highway Administration and the New Jersey Department of Transportation are proposing to take a small portion of Campbell Park for right-of-way to allow for safety, geometric and pavement improvements at the intersection of US Route 9 (Route 9) and Main Street (State Route 88). The taking of property from Campbell Park is part of the proposed safety, geometric, congestion and pavement improvements along a 6.9-mile section of Route 9 between Milepost 95.0 (near Swain Avenue) in Toms River Township, Ocean County and Milepost 101.9 (near 2nd Street) in Lakewood Township, Ocean County in connection with the Route 9, Indian Head Road to Central Avenue /Hurley Avenue Pavement project.

The requirements for a *de minimis* impact finding are that the project does not adversely affect the activities, features, and attributes that qualify the resource for protection under Section 4(f); the officials with jurisdiction over the property are informed of the intent to make the *de minimis* impact finding based on their written concurrence; and the public has been afforded an opportunity to review and comment on the effects of the project on the protected activities, features, and attributes of the Section 4(f) resource.

The proposed impacts include the taking of approximately 447 square feet (0.010 acres) of park property which will allow for needed right-of-way to construct safety and geometric improvements at the intersection and to allow for a new ADA (Americans with Disabilities Act of 1990) compliant peripheral sidewalk. During project construction, Campbell Park will remain open and accessible to residents and users of the park except for closure of the sidewalk at the corner of Route 9 and Main Street during the construction of the sidewalk and ADA facilities. And none of the park facilities nor its function will be impacted except for the construction of safety and geometric improvements at the intersection.

Additional information can be found on the Lakewood Township Website at www.lakewoodnj.gov

Written comments on the finding of *de minimis* impacts may be submitted to Ms. Tina Shutz, Environmental Specialist 4, NJDOT, P O Box 600, Trenton, NJ 08625-0600. Public comment on the proposed impacts to the Campbell Park will be accepted until October 27, 2017.

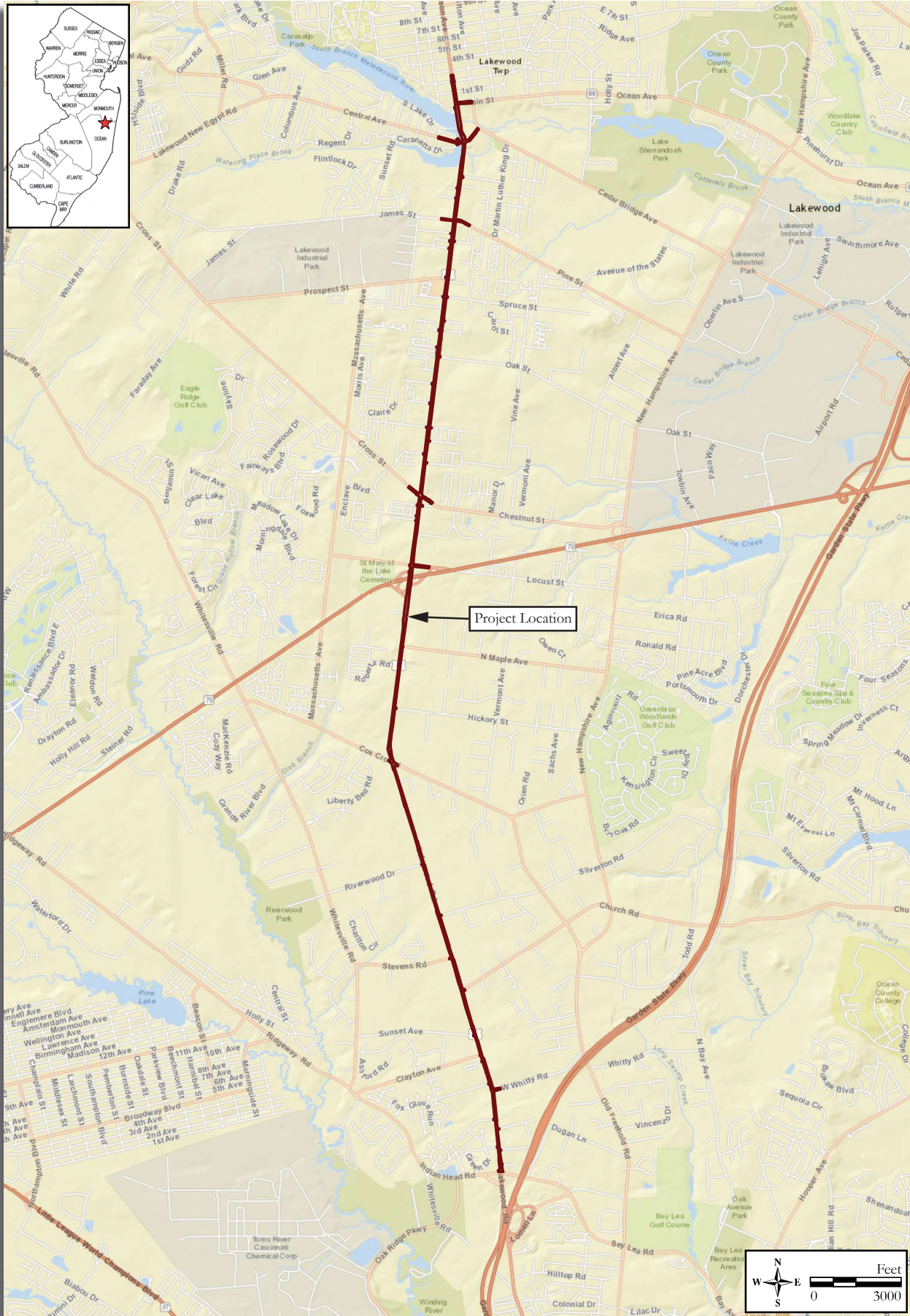

Figure 2: County Map (World Street Map, ESRI 2013).

b "B" a
 Gr. = 53.66 (RAS)
 a Inv. = 49.26
 b Inv. = 49.16

PROPOSED CROSSWALK
 PC 458+14.71

"B" Gr. = 55.74 (RAS) D.C.
 (Silted)

Route 9 SB



PROPOSED CURB RAMP

PROPOSED CURB RAMP

PROPOSED ISLAND
 Existing Curb

Route 9 NB

PROPOSED CURB

Gr. = 55.32 (RAS)
 Inv. = 49.72

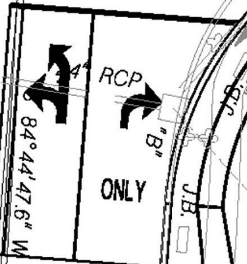
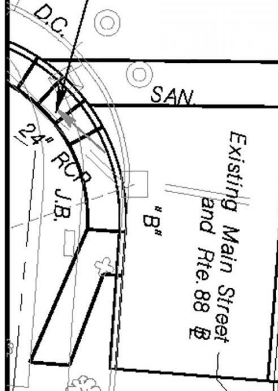

PROPOSED SIDEWALK

PROPOSED R.O.W. LINE

Gr. = 55.17 (RAS)
 Inv. = 49.37

ACQUISITION AREA = 447 S.F.

Existing R.O.W. Line

CAMPBELL PARK

N/F
 TOWNSHIP OF LAKEWOOD

BLOCK 89

LOT 16



Main Street / Rte. 88

#JC1321TD
 w. Light
 Guy

Grass
 Conc. Sidewalk

POB
 000+8

Conc. Sidewalk

Conc. Sidewalk

**ROUTE 9, INDIAN HEAD ROAD TO
 CENTRAL AVE / HURLEY AVE.**

CAMPBELL PARK

4(f) DETERMINATION

SEPTEMBER 26, 2017

SCALE 1" = 30'





ROUTE
US 9
00000009__

Milepost 102.164

Speed Limit 40 MPH

Other Camera Angles

Direction Northbound

City Lakewood Twp (Ocean County)

Right Shoulder Camera



Front Camera



Left Shoulder Camera



Back Camera



Photo #1 of 1

Latitude 40.0899

Longitude -74.2162

[View in GoogleMaps](#)

Photo Date 08/08/2014

Federal Aid NHS

Jurisdiction N.J.D.O.T.

Traffic Volume 31134

Functional Class Urban Principal Arterial – Other

Page 3 of 3